

wooke
ROCK DRILL EQUIPMENT
五环欧科



潜孔钻杆
DTH DRILL PIPES

C 目录
ONTENT

企业简介 Company Profile	-----	1
轻型潜孔钻杆 DTH Light-weight Drill Pipe	-----	4
常规潜孔钻杆 DTH Standard Flush Joint Drill Pipe	-----	6
转换接头 Adapter and Sub	-----	10
钻杆扳手 Wrenches for drill pipes	-----	12

企业简介

COMPANY INTRODUCTION

五环钻机具有限责任公司创立于1995年，位于世界水电名都——宜昌。是一家经三峡工程打造，引领行业发展的创新型企业，是国家高新技术企业、湖北省隐形冠军企业、中国钎钢钎具协会常务理事单位。

公司专注于制造高压潜孔冲击器、钻头、钻杆；顶锤式螺纹钻头、钎尾、连接套；反循环式潜孔冲击器、钻头；各类偏心、同心跟管钻具。应用于露天石场、采矿、水利水电、地质勘探等工程领域。

“专注品质，追求卓越”。公司拥有多项颠覆性专利和高压潜孔钻具制造技术；独创旋风、威猛系列潜孔冲击器，领先全国及世界，并成功实现了产品转型升级、传统生产向智能化生产的跨越。综合实力处于国内行业领先地位。

Established in 1995, Wooke Rock Drill Equipment Co Ltd is located in the city of Yichang, known for the worldwide famous hydroelectric project “Three Gorges Dam”. With the products testified by Three Gorges Project, we are an innovative enterprise pioneering the industry development. Our company has been awarded as “National High-Tech Enterprise”, “State Invisible Enterprise Champion”, and is a current “Executive Member of China Rock-Drill Steel and Tools Association”.

Our company focuses on manufacturing high air pressure DTH hammers, bits, drill pipes, top hammer threaded button bits, shank adapters, coupling sleeves, RC hammers and bits, and a variety of eccentric and symmetric casing systems, which are widely used in open-pit quarry, mining, water and hydropower projects, geological exploration etc.

“Focus on quality, strive for excellence” is our motto. Our company has a number of disruptive product patents and intellectual properties in high air pressure DTH rock drilling tools manufacturing technologies. We have exclusively designed and launched TND series、Wooke series DTH products, both are cutting-edge domestically and internationally, and have successfully transformed from traditional production to intelligentized automatic production. Our comprehensive competitiveness is ranking among the leading positions in China.





▲ 意大利吉埃斐公司生产热处理生产线
Italy Ji Aifei produced heat treatment production line

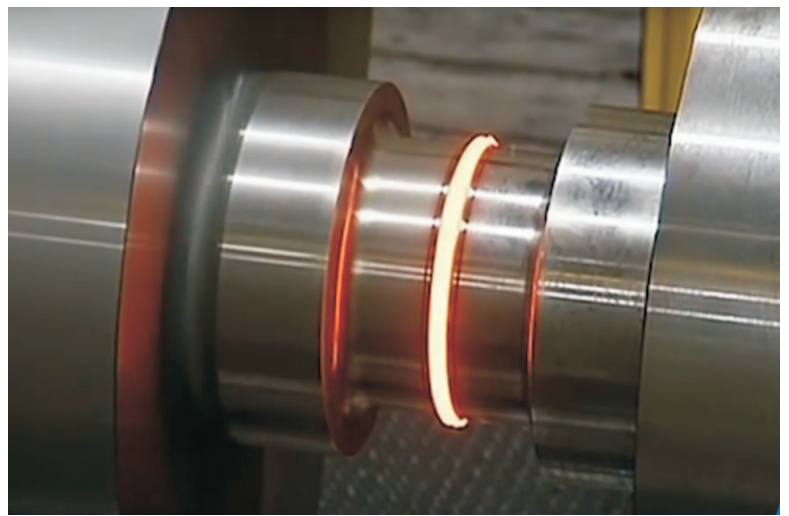

▲ 摩擦焊生产线
Friction Welding



▲ 现代高档数控生产线(金加工)
Modern CNC production lines (metal processing)



API thread Drill Pipe matched up with Drill Rig — we're doing pretty well

- 标准API螺纹及螺纹导向加工一次完成，是我们的工艺诀窍。

Standard API thread forming and orientating processed at one step, which is our technical highlight.

- 每一个工艺环节不被忽略，R圆弧都用数控加工。

Each processing step is stringently controlled, all R arcs are CNC machined.

- 不是摩擦焊接就一定牢固，只有经过了特殊工艺处理的摩擦焊，能确保焊接质量。
Not all friction welding is strong, after a specialized friction welding process, welding outcome can be ensured.

- 接头采用优质合金钢材料、严格热处理及应用标准API螺纹加工技术,这些容易被折扣的地方我们做的很认真，确保稳定性和丝扣耐用性。

Premium alloy steel made joints, strictly controlled heat treatment process and standard API thread processing technology; we pay high attention to all these easily ignored details to ensure pipe stability and thread durability.

- 高强度和耐磨性匹配优质合金钢管，由国家知名特钢厂供应，（钢管厚度和材质可供用户选择）。

Hardness and wear resistance combined alloy steel, supplied by national top level specialsteel manufacturer. (Pipe thickness and material can be users' choice)

- 钻杆弯曲校正正是每支钻杆必须完成的工艺步骤。

Pipe curvature correction is a must process for each drill pipe



轻型潜孔钻杆 DTH Light-weight Drill Pipe

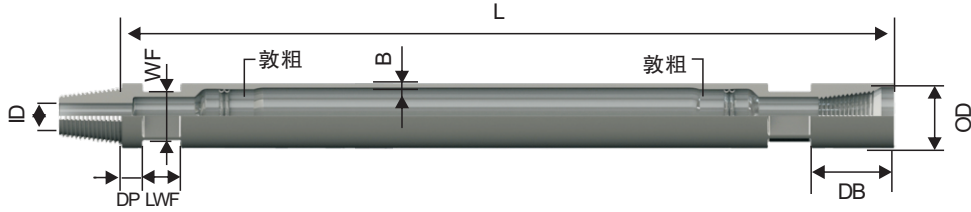

外径(mm)	壁厚(mm)	连接螺纹	有效长度(mm)	重量(kg)	内径(mm)	扳手槽尺寸(mm)			
OD	Wall B	Connection	Length L	Weight	ID	WF	LWF	DP	DB
76	4.0	2 $\frac{3}{8}$ " REG	1000	11.8	32	57x57	48	25	95
			1500	15.3					
			2000	18.8					
			3000	26.8					
			4500	37.8					
			6000	48.8					
			1000	12		65x65	42		
			1500	15.5					
			2000	19					
			3000	27					
			4500	38					
			6000	49					
89	4.0	2 $\frac{3}{8}$ " REG	1000	15.5	32	65x65	45	28	75
			1500	20					
			2000	24					
			3000	33					
			4500	45.5					
			6000	59					
			1000	15.5	40	75x75	18	97	
			1500	20					
			2000	24					
			3000	33					
			4500	45.5					
			6000	59					

外径(mm)	壁厚(mm)	连接螺纹	有效长度(mm)	重量(kg)	内径(mm)	扳手槽尺寸(mm)						
OD	Wall B	Connection	Length L	Weight	ID	WF	LWF	DP	DB			
89	4.0	2 $\frac{3}{8}$ " IF	1000	16	40	65x65	45	22	94	114		
			1500	20.5								
			2000	24.5								
			3000	33.5								
			4500	46.0								
			6000	59								
		2 $\frac{7}{8}$ " REG	1000	16.2		75x75						
			1500	20.7								
			2000	24.7								
			3000	33.7								
			4500	46.2								
			6000	59.2								
			1000	16							13.1	102
			1500	21								
2000	25											
3000	34											
4500	46.5											
6000	60											
102	6.5	2 $\frac{7}{8}$ " REG	1000	24	40	90x90	45	13.1	102			
			1500	32								
			2000	39								
			3000	54								
			4500	77								
			5000	85								
			6000	100								

常规潜孔钻杆 Standard Flush Joint Drill Pipe

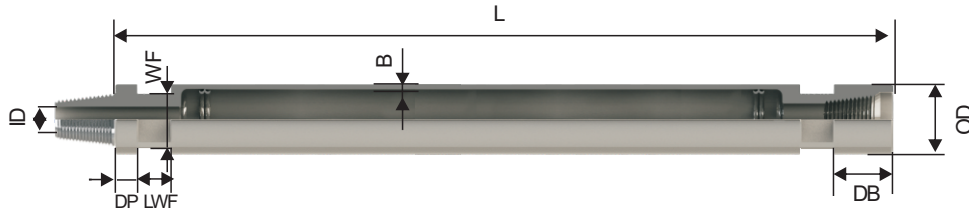

外径(mm)	壁厚(mm)	连接螺纹	有效长度(mm)	重量(kg)	内径(mm)	扳手槽尺寸(mm)							
OD	Wall B	Connection	Length L	Weight	ID	WF	LWF	DP	DB				
63.5	5.5	1" / 6牙、2 1/16" 12° 锥螺纹	1000	13	28	40	40	12	40				
			1500	16									
			2000	20									
			3000	27									
76	6	2 3/8" REG	1000	11	32	57x57	48	25	95				
			1500	22									
			2000	27									
			3000	37									
			4500	53									
			6000	69									
			1000	11		65x65	42						
			1500	22									
			2000	27									
			3000	37									
			4500	53									
			6000	69									
89	6.5	2 3/8" REG	1000	22	32	65x65	45	28	75				
			1500	28									
			2000	35									
			3000	48									
			4500	68									
			6000	88									
		2 3/8" IF			1000			22.5	37			22	114
					1500			28.5					

外径(mm)	壁厚(mm)	连接螺纹	有效长度(mm)	重量(kg)	内径(mm)	扳手槽尺寸(mm)			
OD	Wall B	Connection	Length L	Weight	ID	WF	LWF	DP	DB
89	6.5	2 $\frac{3}{8}$ " IF	2000	35.5	37	65x65	45	22	114
			3000	48.5					
			4500	68.5					
			6000	88.5					
		2 $\frac{7}{8}$ " REG	1000	23		75x75		13.1	102
			1500	29					
			2000	36					
			3000	49					
			4500	69					
			6000	89					
102	8.5	2 $\frac{7}{8}$ " REG	1000	34	37	90x90	45	13.1	102
			1500	43					
			2000	53					
			3000	73					
			4500	103					
			5000	112					
			6000	132					
		2 $\frac{7}{8}$ " IF	1000	32	44	40	25	114	
			1500	41					
			2000	50					
			3000	69					
			4000	88					
			4500	97					
			5000	107					
6000	125								
114	8.5	3 $\frac{1}{2}$ " REG	1000	39	44	95x95	45	28	75
			1500	50					
			2000	62					
			3000	84					
			4500	117					
			6000	151					

外径(mm)	壁厚(mm)	连接螺纹	有效长度(mm)	重量(kg)	内径(mm)	扳手槽尺寸(mm)			
OD	Wall B	Connection	Length L	Weight	ID	WF	LWF	DP	DB
114	8.5	3 $\frac{1}{2}$ " IF	1000	37	50	95x95	45	28	75
			1500	48					
			2000	58					
			3000	79					
			4500	110					
			6000	142					
127	10	3 $\frac{1}{2}$ " IF	1000	48	50	105x105	40	23	125
			1500	61					
			2000	75					
			3000	104					
			4500	145					
			6000	187					
140	12	4 $\frac{1}{2}$ " REG	1000	69	58	121x121	42	28	122
			1500	87					
			2000	105					
			3000	140					
			4500	195					
			6000	249					

阿特拉斯F6/L6/L8钻杆

Design group Atlas Copco Roc F6/L6/L8

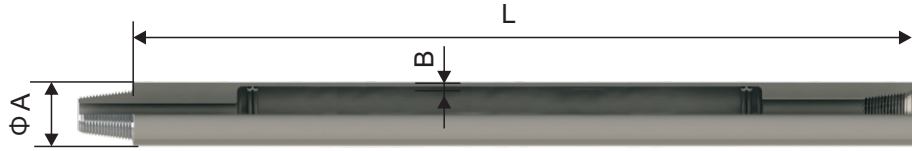

外径(mm)	壁厚(mm)	有效长度(mm)	扳手槽尺寸(mm)	扳手槽长度(mm)	扳手尺寸(mm)	连接螺纹
OD A	Wall B	Length L	Across Flat C	Flat Length E	Across Flat G	Connection P/N
76	6.3	4000	—	—	—	2 ³ / ₈ " REG
		5000	—	—	—	2 ³ / ₈ " REG
89	6.5	4000	—	—	—	2 ³ / ₈ " REG
		5000	—	—	—	2 ³ / ₈ " REG
		6000	—	—	—	2 ³ / ₈ " REG
89	8.8	6000	—	—	—	2 ³ / ₈ " REG
	102	6.5	4000	—	—	—
5000			—	—	—	2 ⁷ / ₈ " REG
6000			—	—	—	2 ⁷ / ₈ " REG
114	6.3	6000	—	—	—	3 ¹ / ₂ " REG
	8.8	6000	—	—	—	3 ¹ / ₂ " REG
		6000	—	—	—	4 ¹ / ₂ " REG

CM760/780钻杆

Design group CM(CM760/780)

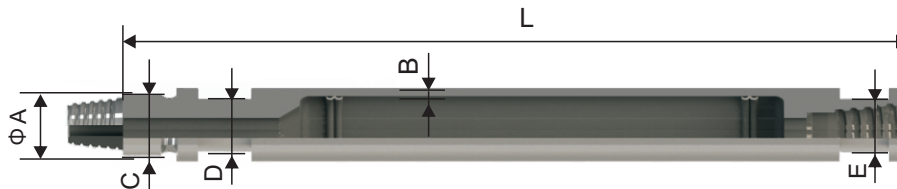

外径(mm)	壁厚(mm)	有效长度(mm)	扳手槽长度(mm)	扳手槽尺寸(mm)	扳手尺寸(mm)	连接螺纹
OD A	Wall B	Length L	Across Flat C	Flat Length D	Across Flat E	Connection P/N
102	8.5	4400	86	76	76	2 ¹ / ₂ " Z/3 ¹ / ₂ " REG
		5000				2 ¹ / ₂ " Z/2 ¹ / ₂ " REG

山河智能SW DB165 SW DB165 Series Drill Pipe

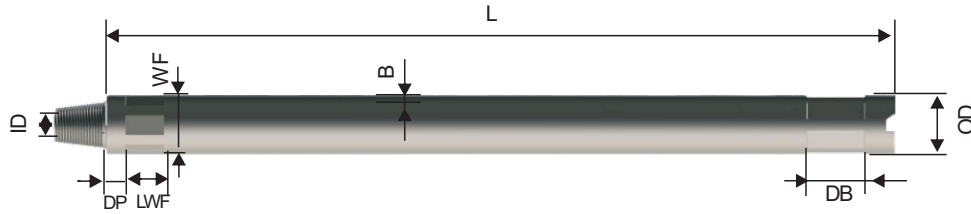

外径(mm)	壁厚(mm)	连接螺纹	有效长度(mm)	重量(kg)	内径(mm)	扳手槽尺寸(mm)			
OD	Wall B	Connection	Length L	Weight	ID	WF	LWF	DP	DB
108	15	3½" REG	8245	298	38+2	102x6方	105	35	105

内外接头 Box-pin adapters

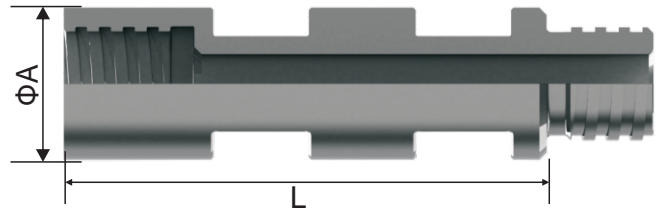
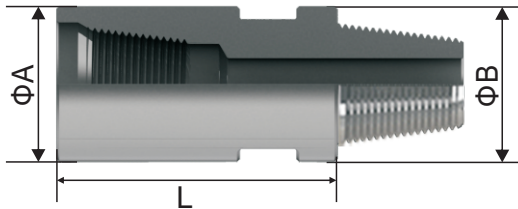

螺纹 API Threads		扳手槽 Wrench flats	长度 Length	直径 Dia. (mm)		单重 Weight	件号 Part No.
内 Box	外 Pin	(mm)	(mm)	A	B	(kg)	
2 ³ / ₈ " REG	2 ³ / ₈ " REG	65	140	77	77	4.0	JT2-1010-140065
				89	89	5.5	JT2-1010-140065-A
	2 ³ / ₈ " IF		144				JT2-1011-140065
	2 ⁷ / ₈ " REG		130	95	95	8.0	JT2-1020-130065
	3 ¹ / ₂ " REG		95	120	102	102	10.5
2 ³ / ₈ " IF	2 ³ / ₈ " REG	65	164	89	89	6.8	JT2-1110-164065
154			6.5			JT2-2011-154065	
2 ⁷ / ₈ " REG	3 ¹ / ₂ " REG	95	120	114	114	11	JT2-2030-120095
3 ¹ / ₂ " REG	2 ³ / ₈ " REG		219	114	90	12.5	JT2-3010-219095
	2 ³ / ₈ " IF		160	114	114	10.5	JT2-3011-160095
	2 ⁷ / ₈ " REG					10.8	JT2-3020-160095
	2 ⁷ / ₈ " IF					10.8	JT2-3021-160095
	3 ¹ / ₂ " REG	10.5				JT2-3030-160095	
4 ¹ / ₂ " REG	120	132	115	146	16.0	JT2-3040-132120	
4 ¹ / ₂ " REG	3 ¹ / ₂ " REG	95	235	146	115	17.0	JT2-4030-235095
F48	F42	40	203	59	59	4.6	JT2-7060-203040
	F48					5.0	JT2-7070-203040
	2" REG					5.2	JT2-7080-203040

内接头 外接头

Box-Box adapters Pin-Pin adapters

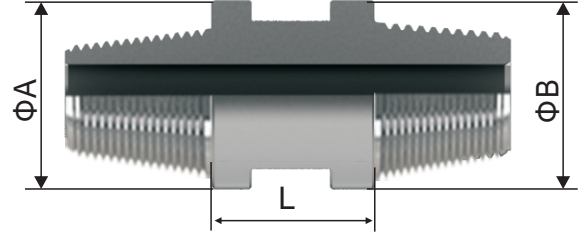
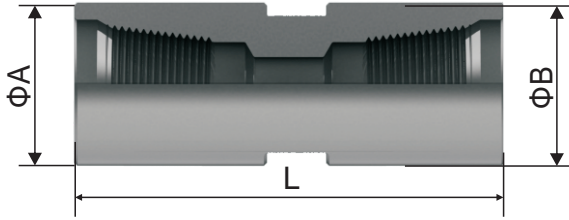

螺纹 API Threads		扳手槽 Wrench flats	长度 Length	直径 Dia. (mm)		单重 Weight	件号 Part No.
内/内 Box/Box	外/外 Pin/Pin	(mm)	(mm)	A	B	(kg)	
2 ³ / ₈ " REG/2 ³ / ₈ " REG	—	65	200	77	77	4.5	JT1-1010-200065
	—					5.8	JT1-1010-200065-A
2 ³ / ₈ " REG/2 ³ / ₈ " IF	—	65	220	89	89	6.0	JT1-1011-220065
2 ³ / ₈ " REG/2 ⁷ / ₈ " REG	—		225			6.2	JT1-1020-225065
2 ³ / ₈ " REG/2 ⁷ / ₈ " IF	—		220			6.0	JT1-1021-220065
2 ³ / ₈ " IF/3 ¹ / ₂ " REG	—		95			210	90
2 ³ / ₈ " IF/2 ³ / ₈ " IF	—	65	230	89	89	6.2	JT1-1111-230095
2 ³ / ₈ " IF/6 ¹ / ₂ " REG	—	171	260	180	114	21.0	JT1-1160-260171
2 ³ / ₈ " IF/7 ¹ / ₂ " REG	—	180	270	205	120	28.2	JT1-1170-270180
3 ¹ / ₂ " REG/2 ³ / ₈ " IF	—	95	200	114	90	9.0	JT1-3011-200095
3 ¹ / ₂ " REG/2 ⁷ / ₈ " REG	—		230			10.0	JT1-3020-230095
3 ¹ / ₂ " REG/2 ⁷ / ₈ " IF	—		220	114	115	10.5	JT1-3021-220095
3 ¹ / ₂ " REG/3 ¹ / ₂ " REG	—		220			10.5	JT2-3030-220095
3 ¹ / ₂ " REG/4 ¹ / ₂ " REG	—	120	240	115	146	18.0	JT2-3040-240120
—	2 ³ / ₈ " REG/2 ³ / ₈ " REG	65	70	89	89	5.0	JT3-1010-070065
—	2 ³ / ₈ " REG/3 ¹ / ₂ " REG	95	97	89	114	9.0	JT3-1030-097095
—	3 ¹ / ₂ " REG/3 ¹ / ₂ " REG		90	114	114	10.0	JT3-3030-090095

钻杆扳手

Wrenches for drill pipes

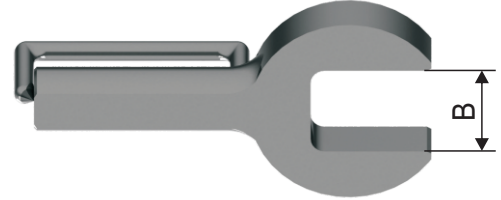

扳手槽 B	件号
Wrench flats B	Part No.
28	BS1-028
40	BS1-040
57	BS1-057
65	BS1-065
75	BS1-075
95	BS1-095
102	BS1-102
120	BS1-120
140	BS1-140

扳手槽 B	件号
Wrench flats B	Part No.
40	BS2-040
57	BS2-057
65	BS2-065
75	BS2-075
95	BS2-095
102	BS2-102
120	BS2-120

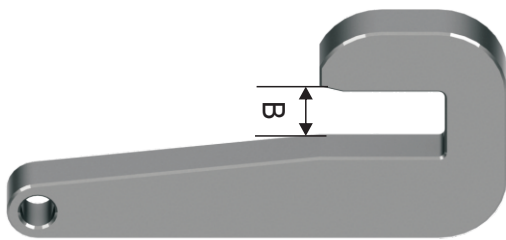

扳手槽 B	件号
Wrench flats B	Part No.
57	BS3-057
65	BS3-065





宜昌市五环钻机具有限责任公司

地址：湖北省宜昌市伍家岗工业园
邮编：443000
电话：0717-6343890
传真：0717-6262008
邮箱：info@wookechina.com
网址：www.wookechina.com

WOOKE ROCK DRILL EQUIPMENT CO.,LTD

ADD:Wujiagang Industrial Zone,Yichang,Hubei,China
Tel:+86-717-6343815 / 6262131
Fax:+86-717-6262118
E-mail:info@wooke-intl.com
MSN:wooke-intl@hotmail.com
Http://www.wooke-intl.com